

May 9, 2022  
Projects 18-1380/11-2380

**NOTICE FOR LOADING/UNLOADING, DELIVERIES TO BUSINESSES - UPDATED  
(Stage 1 – Queen Street East)  
Watermain, Sanitary Sewer Replacement, Road Repairs and Resurfacing**

**What are we doing with current traffic and deliveries?**

- During Construction, our Contractor will occupy the two middle lanes. Queen Street will be reduced to one lane in each direction.
- On-street parking will be removed and converted into through traffic lanes. Parking garages will be available for parking.
- Any deliveries or loading/unloading for businesses and residents shall be done through the laneways or John Street, as mentioned in this notice below.

**When?**

- The work will begin from the east limit of the project (Chapel/Queen) and the operation will move westerly towards Main Street.
- The duration of this traffic control setup will be in place for about 2-3 months, but that is subject to weather and soil conditions.

**Traffic and Parking Control**

- During this stage, on-street parking on Queen Street will not be available (*Figure 1 below*).
- Parking garages in the area can be used for parking instead (free of charge). There are five parking garages: Nelson Square, Market Square, West Tower, City Hall and John Street Garage. (*Figure 2 on next page*).

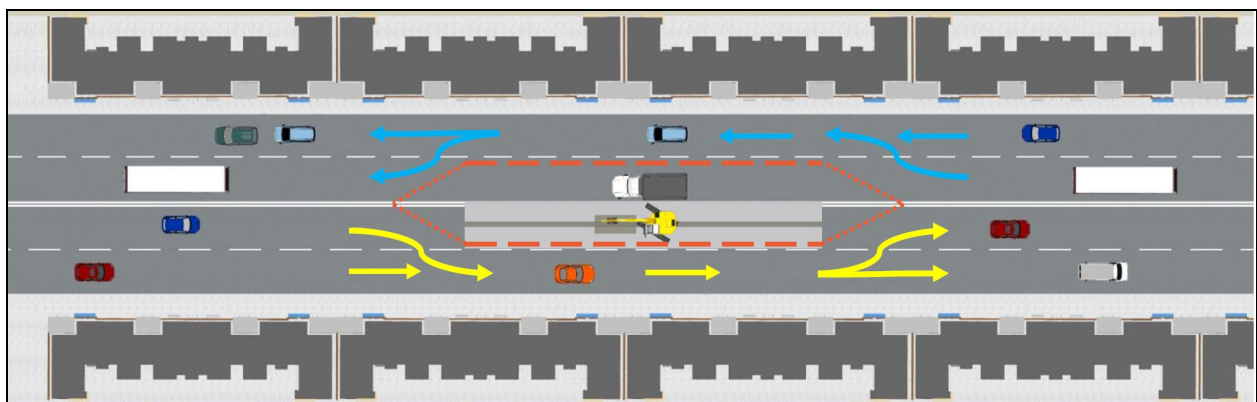

*Figure 1: Illustration of traffic flows on Queen Street for Stage 1.*

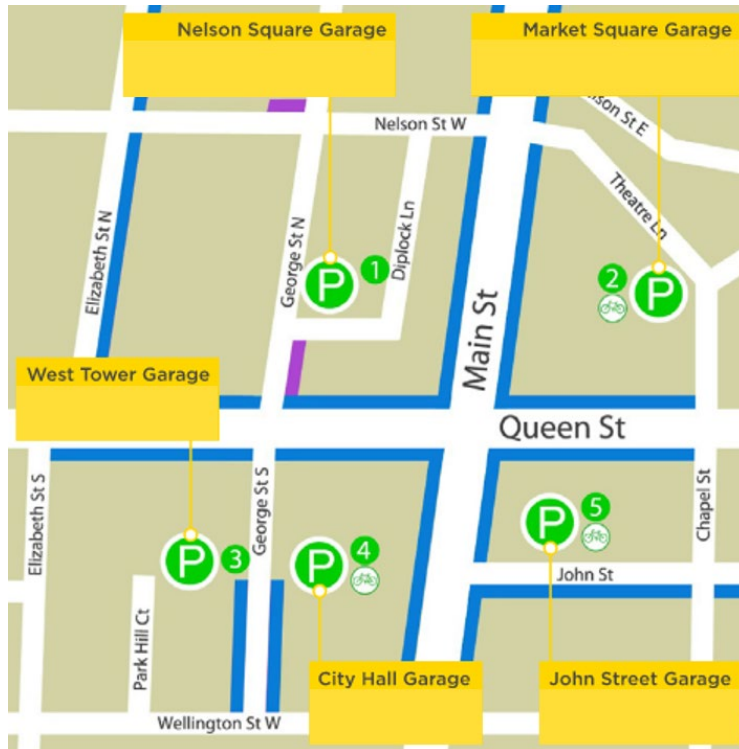

Figure 2: Parking garages will be available at no cost, instead of on-street parking.

**Use of Laneways for Deliveries, Loading/Unloading:**

- We will make sure businesses have access at all times, through the laneways in the back of the buildings. In this stage, Harmsworth Lane and Garden Square Lane can be utilized for facilitating deliveries and loading/unloading for businesses (See Figure 3 below).

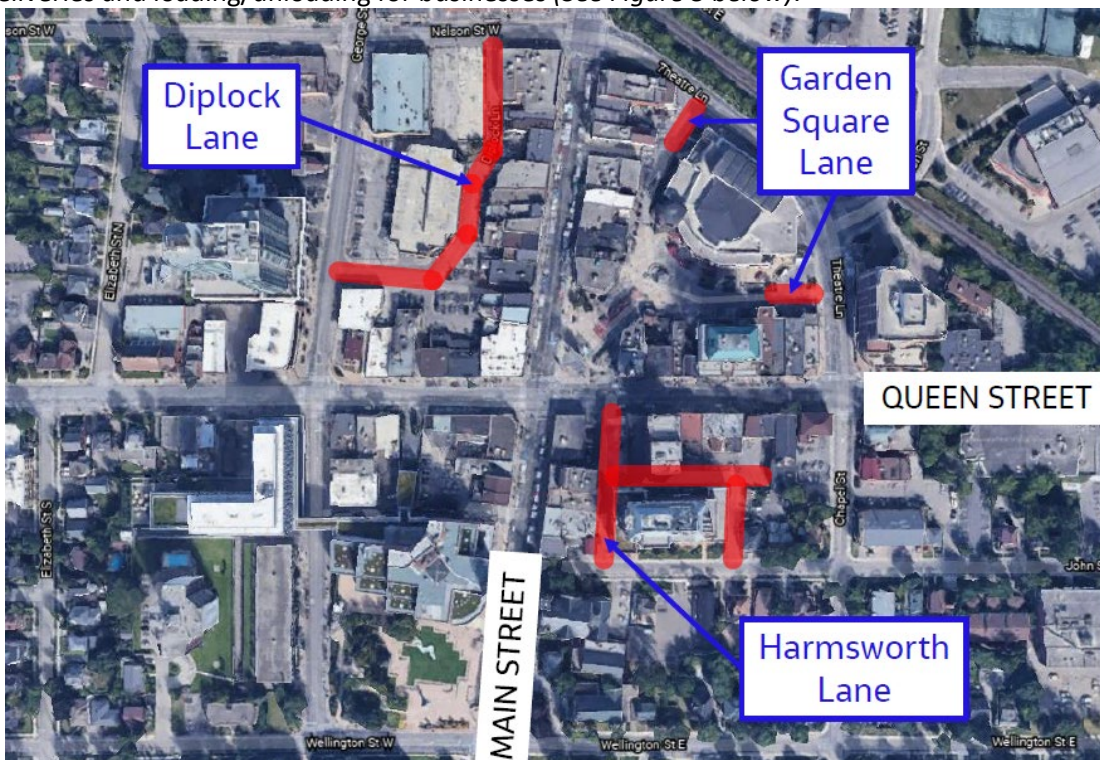

Figure 3: Laneways to be used for business deliveries, loading/unloading.



### Use of John Street and Main Street South for Deliveries and Loading/Unloading:

- The on-street parking on John Street has been turned into a loading/unloading zone for businesses south of Queen Street East (highlighted in yellow in Figure 4 below). All larger delivery trucks should use the John Street loading zones and all smaller deliveries can continue to utilize Harmsworth Lane. Trucks will not be able to turn right from Harmsworth Lane onto Queen Street safely with enough space.
- Please follow the No Parking Zone signs on Harmsworth Lane, Unauthorized vehicles will be towed.



Figure 4: John Street used for loading/unloading.

### Project Updates

- Our Project Ambassador (Avalon Myers) can be contacted for further information.  
Cell: 416-457-3889, Email: [avalon.myers@peelregion.ca](mailto:avalon.myers@peelregion.ca)
- Information on this project can also be found at [peelregion.ca/downtownbrampton](http://peelregion.ca/downtownbrampton)

### Sign up for email notices

Receive timely project updates right to your inbox by signing up for e-notices at [peelregion.ca/construction](http://peelregion.ca/construction).

Cc: Regional Councillors: R. Santos, P. Vicente, M. Medeiros (Wards 1 and 3)  
City Councillors: J. Bowman (Ward 3)

### Construction statement regarding COVID-19

Critical infrastructure construction is an essential service. We're keeping employees, contractors and the community safe by complying with [provincial guidelines](#), physical distancing, using personal protective equipment, and adjusting work schedules and shifts.

Construction project updates can be found at [www.peelregion.ca/downtownbrampton](http://www.peelregion.ca/downtownbrampton)

Follow [Peel Public Works on Twitter](#) for service updates and changes.